

SolarInvert Energy Solutions

**Is the communication room far
from the base station**



Overview

A cell is a network coverage area created by transmitting and receiving signals from the antennas of a radio base station. The cells are defined by the range (in kilometres) within which the base station can tra.

What is a base station in radio communications?

In radio communications, a base station is a wireless communications station installed at a fixed location and used to communicate as part of one of the following: a wireless telephone system such as cellular CDMA or GSM cell site. Base stations use RF power amplifiers (radio-frequency power amplifiers) to transmit and receive signals.

What is a base station in a cellular telephone network?

Base stations in cellular telephone networks are more commonly referred to as cell towers. Each cellphone connects to the cell tower, which in turn connects it to the wired public switched telephone network (PSTN), the internet or to other cellphones within the cell.

How does a base station communicate with a client device?

Generally, if client devices wanted to communicate to each other, they would communicate both directly with the base station and do so by routing all traffic through it for transmission to another device. Base stations in cellular telephone networks are more commonly referred to as cell towers.

Why are base stations important in cellular communication?

Base stations are important in the cellular communication as it facilitate seamless communication between mobile devices and the network communication. The demand for efficient data transmission are increased as we are advancing towards new technologies such as 5G and other data intensive applications.

What is the role of a base station in wireless communication?

Base stations are critical components in wireless communication networks,

serving as the intermediary between mobile devices and the core network. They play a vital role in ensuring seamless connectivity, efficient data transmission, and reliable communication services.

What are base stations & cell towers?

Base stations and cell towers are critical components of cellular communication systems, serving as the infrastructure that supports seamless mobile connectivity. These structures facilitate the transmission and reception of signals between mobile devices and the wider network, enabling voice calls, text messages, and data services.

Is the communication room far from the base station



How Far Can a Mobile Talk to a Base Station?

? Urban environments limit communication to hundreds of meters. ? Lab testbeds show even shorter distances due to lower power and interference.

[Get Price](#)

Radio Base Stations for Secure Communication

In the world of radio communications, a radio base station plays a vital role in ensuring reliable and seamless communication across a wide area. Whether used in mobile networks, ...

[Get Price](#)

Highvoltage Battery



Space Communications: 7 Things You Need to Know

Ground station antennas range from the small very high frequency antennas that provide backup communications to the space station to a massive, 230-foot antenna that can ...

[Get Price](#)



Base Stations

The present-day tele-space is incomplete without the base stations as these constitute an important part of the modern-day scheme of wireless communications. They are ...

[Get Price](#)



Base Stations and Cell Towers: The Pillars of Mobile ...

Base stations and cell towers are critical components of cellular communication systems, serving as the infrastructure that supports seamless ...

[Get Price](#)

Base station

In traditional wireless communications, it can refer to the hub of a dispatch fleet such as a taxi or delivery fleet, the base of a TETRA network as used by ...

[Get Price](#)



Cell sites and cell towers in a mobile cellular network

Cell towers or radio base stations are tall masts carrying cellular antennas that you can spot from a distance. A cellular tower can have many antennas installed

on it, and the ...

[Get Price](#)



What Is the Role of a Base Station in Wireless Communication?

Base stations are critical components in wireless communication networks, serving as the intermediary between mobile devices and the core network. They play a vital role in ...

[Get Price](#)



The Base Station in Wireless Communications: The Key to ...

Equipped with an electromagnetic wave antenna, often placed on a tall mast, the base station enables communication between mobile terminals (such as mobile phones or ...

[Get Price](#)



COMMUNICATION SITE BUILDING DESIGN AND ...

The same building design requirements for general communications sites apply to switch room, iDEN Mobile Switching Office (MSO), major dispatch centers, or

central office (CO) design, but ...

[Get Price](#)



What is a Base Station?

A base station is a common term used in telecommunications for a radio receiver with one or more antennae. While the base station has many ...

[Get Price](#)

Base Stations

The present-day tele-space is incomplete without the base stations as these constitute an important part of the modern-day scheme of wireless ...

[Get Price](#)



What Is the Role of a Base Station in Wireless Communication?

Introduction to Base Stations in Wireless Communication Base stations are critical components in wireless communication networks, serving as the intermediary

between mobile ...

[Get Price](#)



Base Stations and Cell Towers: The Pillars of Mobile Connectivity

Base stations and cell towers are foundational to the functionality and expansion of cellular networks. They enable the connectivity that powers our mobile communications and ...



[Get Price](#)



The Base Station in Wireless Communications: The ...

Equipped with an electromagnetic wave antenna, often placed on a tall mast, the base station enables communication between mobile terminals ...

[Get Price](#)

Base station

In traditional wireless communications, it can refer to the hub of a dispatch fleet such as a taxi or delivery fleet, the base of a TETRA network as used by government and emergency services ...

[Get Price](#)

E74

Repeater stations eliminate communication problems, such as the inability to hear, which can occur between a base station and another mobile unit communicating with the same base.

[Get Price](#)

Understanding Underground Radio Communication ...

Fixed Base Stations: Installed at strategic points within the mine, base stations facilitate communication by acting as relay points between ...

[Get Price](#)

Lobby and Machine Room Communication Systems

The SmartRescue System is designed to provide seamless two-way, person-to-person voice communication for elevators, accommodating up to 10 Rath

2100 Series elevator phones on ...

[Get Price](#)



EMF

A base station is made up of antennas connected by cable to electronic (radio) equipment usually housed in a room or 'shelter'. Some base stations have ...

[Get Price](#)



The Common Misconceptions Around Base and Rover RTK

With a base and rover system, your rover is accurate relative to the base. Your base station is not receiving any RTK corrections; therefore, its position is only accurate to ...

[Get Price](#)

Base Station's Role in Wireless Communication Networks

What is a base station? A base station is a critical component of wireless communication networks. It serves as the central point of a network that

connects various devices, such as ...

[Get Price](#)



RADIO COMMUNICATION Flashcards , Quizlet

Approximately how far should you keep the mobile radio microphone from your mouth? What is the most effective form of communications on the fireline? .On major incidents, ICS may utilize ...

[Get Price](#)

What is a base station?

A base station serves as a central connection point for a wireless device to communicate. It further connects the device to other networks or devices, usually through ...

[Get Price](#)



Base stations and networks

The intensity of the radio waves is drastically reduced as the distance increases from the base station antenna. On the ground, in houses, and other places where people reside, the ...

[Get Price](#)

What Is A Base Station?

A base station is an integral component of wireless communication networks, serving as a central point that manages the transmission and ...

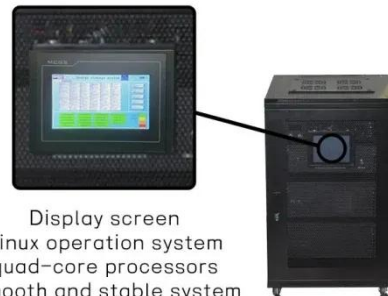
[Get Price](#)

Base Stations and Cell Towers: The Pillars of Mobile ...

Base stations and cell towers are foundational to the functionality and expansion of cellular networks. They enable the connectivity that powers ...

[Get Price](#)

Contact Us

For catalog requests, pricing, or partnerships, please visit:
<https://barkingbubbles.co.za>